

## Step one

# 1

Purchase a 1.8 metre Waratah from Mitre 10.

To install the Waratah, insert 200-300 millimetres into the ground or until the Waratah feels stable.

200 - 300 mm

1.8 Metres

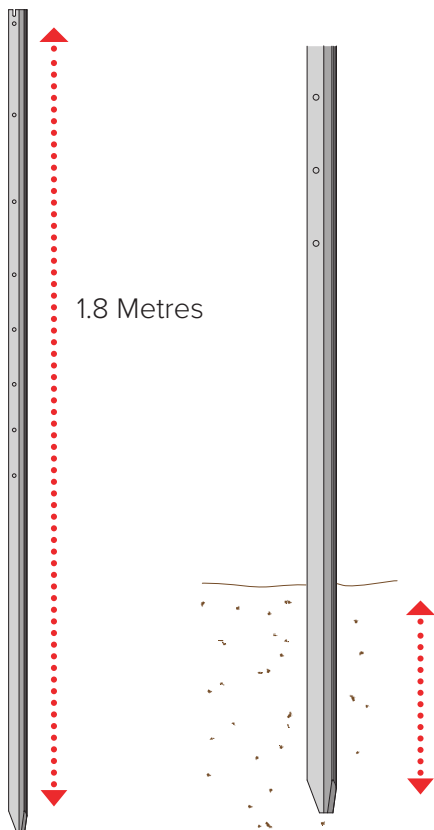

## Step two

# 2

Find the pin that is sellotaped to the underside of the platform and push it through the 3rd hole down from the top of the Waratah.

Line the Waratah shape up with the corresponding shape at the rear of the platform and slide down onto the pin.

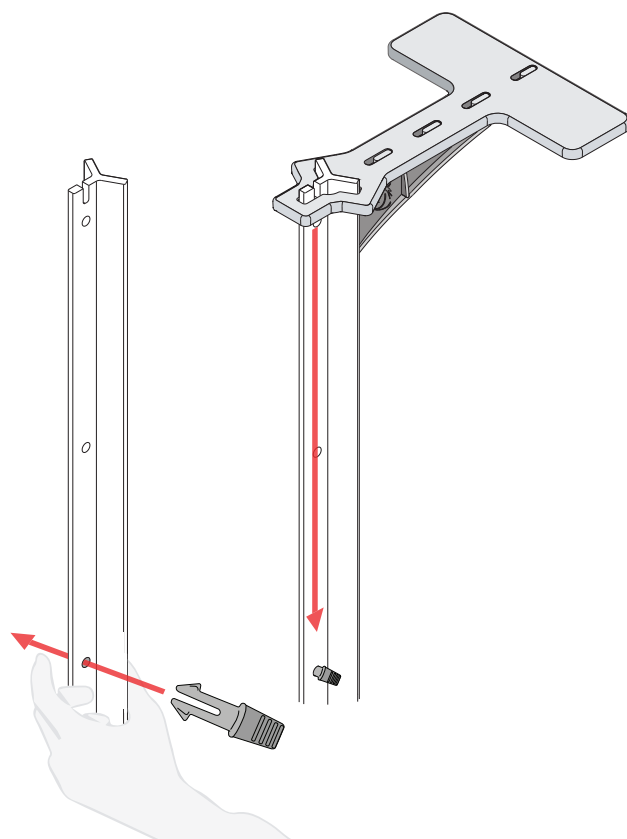

## Step three

# 3

Unbox the TopFlite Truffle Feeder from the small box found inside the PekaPeka package.

Assemble the Truffle Feeder and then hang on the hook found on the underside of the platform.

Then the lid of the Truffle Feeder can be lifted to allow truffles to be placed inside

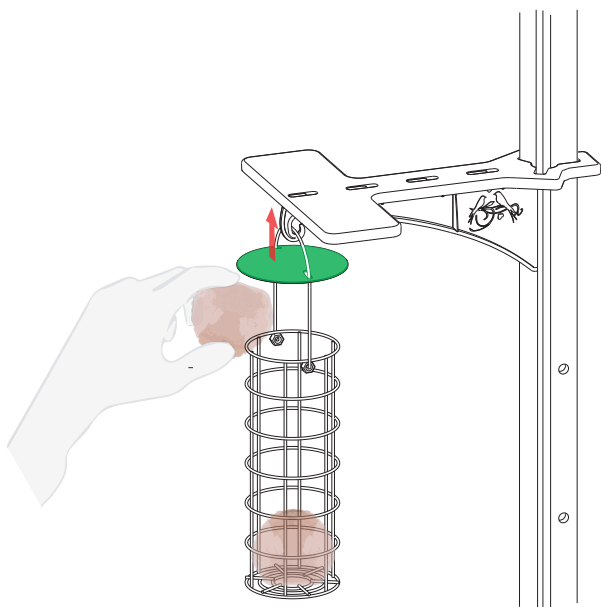
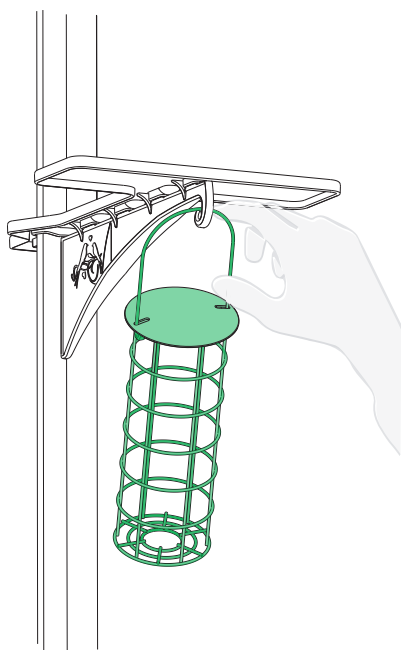

## Step four

# 4

Slide the Nectar Nest spine over the two shorter arms of the Waratah.

Slide all the way down until the cap rests on the top of the Waratah.

Some wiggling and downward force may be necessary to install the spine.

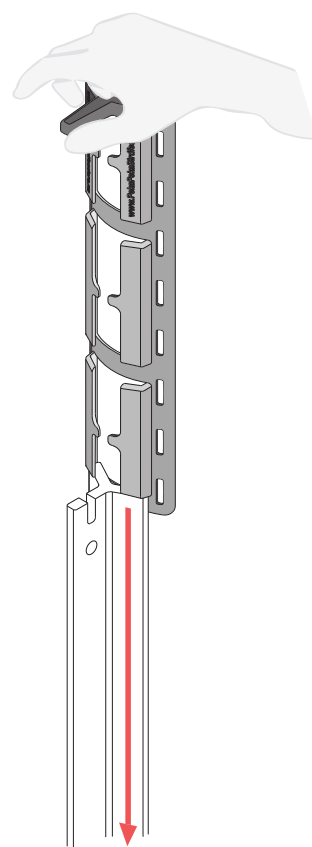

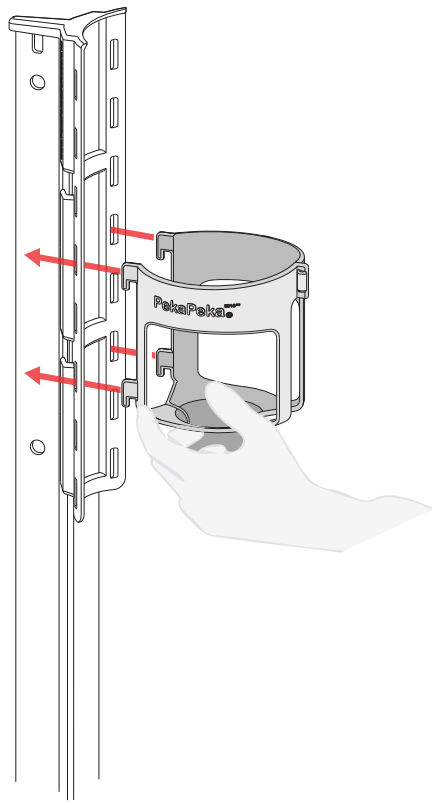

#### Step Five

# 5

After installing the Nectar Nest spine onto the Waratah you can now take the cradle section and attach it with the four hooks.

The four hooks of the cradle slot through the corresponding holes on the spine, the cradle can be installed at a variety of heights by adjusting the slots that the cradle is inserted into.

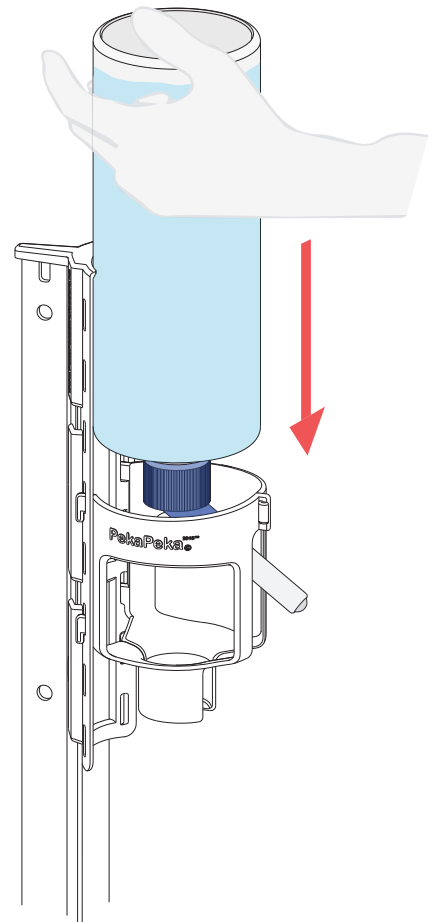

#### Step Six

# 6

Now that the Nectar Nest is complete and installed on the Waratah, the Sugar Water Bottle can be slid easily into the cradle.

The cradle can also be removed and re-inserted in conjunction with the bottle when re-filling the sugar water.

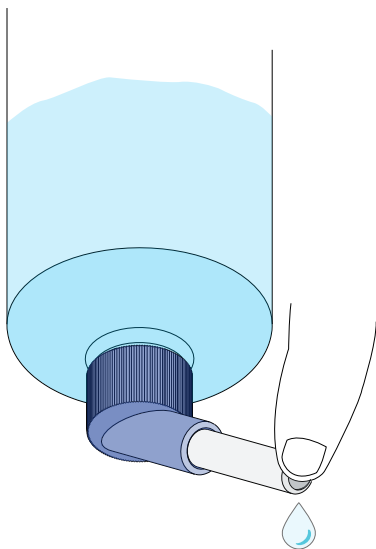

#### Step Seven

# 7

To ensure the sugar water dispenser is working correctly place a finger over the nozzle and push the ball bearing backwards.

A bubble should be visible rising up into the bottle, indicating a vacuum has been created inside.

Hold the nozzle open until the flow reduces to a drip and then release the ball bearing.



Thank you for choosing to feed birds anywhere with PekaPeka!

PekaPeka feeders are specifically designed to feed a wide range of birds in an urban environment, giving birds 360 degree visibility to protect them from ambush predators like cats.

Nozzle may be tricky to screw on at first as it is quite a tight fit to ensure an effective vacuum within the bottle. Push the nozzle firmly on to the bottle neck and then twist on as normal. If problems persist please contact us and we can send a bottle with a nozzle pre attached.

### **Installation process:**

- . Purchase a 1.8m (minimum height) to 2.4m waratah from Mitre 10 or Bunnings to combine with pack contents.
- . First choose a spot for your PekaPeka. It is great to place the feeder where you can easily watch birds from the comfort of your home.
- . The waratah is most stable pushed 200-300mm down into the ground.
- . Once you have chosen a spot, slide the PekaPeka platform down the waratah and secure the platform using the plastic pin provided. The platform rests upon the pin, securing it stably.
- . The best height for tui, bellbirds and silver eyes is the 3rd hole down on the waratah.
- . Next fill your sugar water bottle and secure it to the waratah above the platform with the Nectar Nest Bottle holder provided. The best height is the top of the bottle in line with the top of the waratah. If the bottle seems to be leaking, refer to the instruction sheet provided. A tip to help the birds find the sugar water is to add some food colouring at the start to help guide them in.
- . The last step is to add your hanging feeder and food, sit back relax and enjoy the bird show!

It may take a couple of days for the birds to realise the PekaPeka feeder is there for them, but once they do they will always be back for more!

Please do not hesitate to contact us further and we would love any photos for our website and social media!

Thanks again for helping feed birds anywhere, the more you feed the more they breed!

Tahu and Harvey  
PekaPeka Limited  
22 Orbell Street, Dunedin 9010  
021 065 13 14      PekaPekaLtd@gmail.com

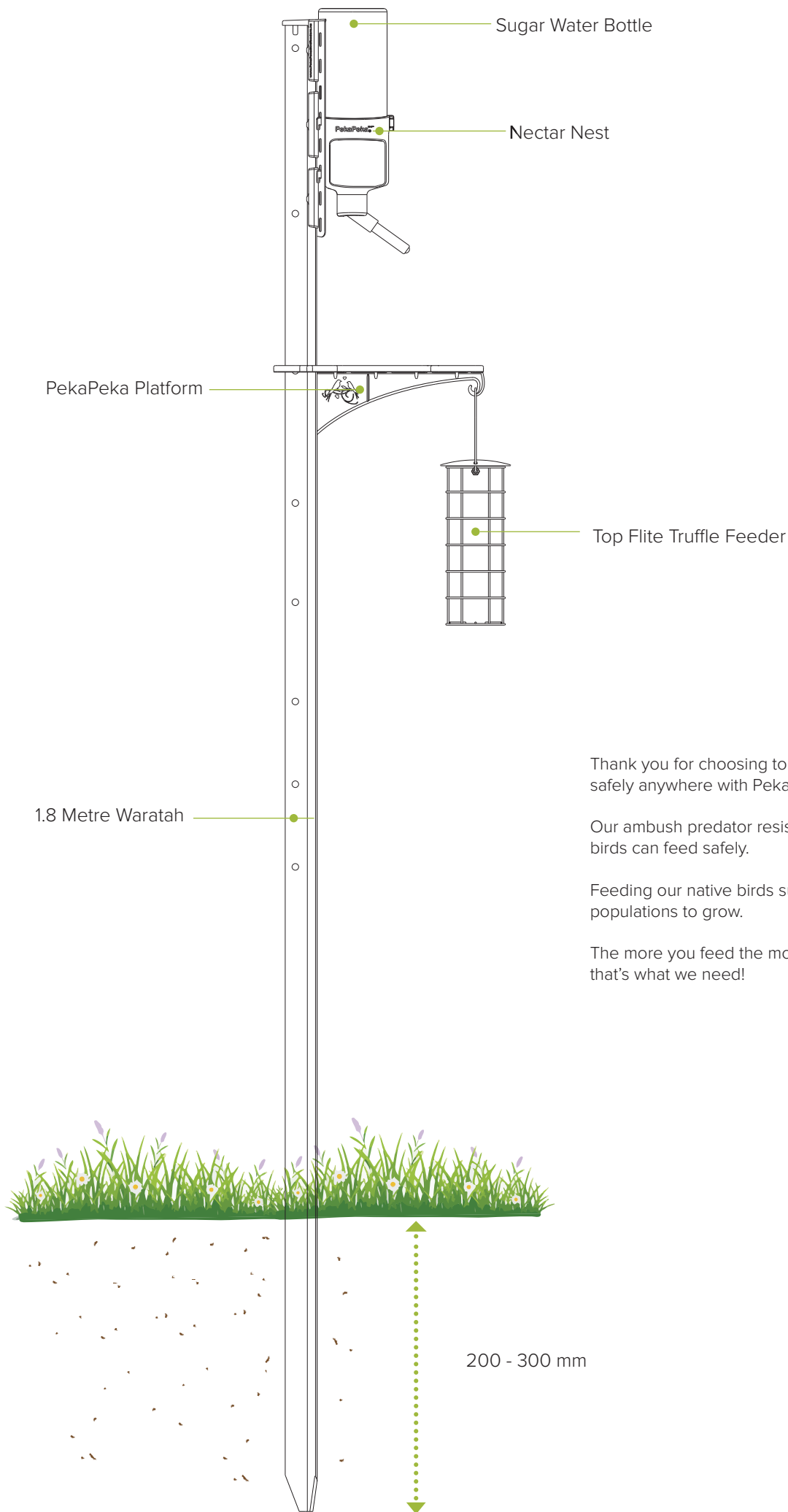

Sugar Water Bottle

Nectar Nest

PekaPeka Platform

Top Flite Truffle Feeder

1.8 Metre Waratah

Thank you for choosing to feed native birds safely anywhere with PekaPeka Birdfeeders!

Our ambush predator resistant design means birds can feed safely.

Feeding our native birds supports their populations to grow.

The more you feed the more they breed and that's what we need!

200 - 300 mm